



# National Train Show®

## Connecticut Convention Center

### Hartford, CT

### Halls A & B

### July 10 - 12, 2009



Original  
22 April 2008  
Revision #1  
5 June 2008

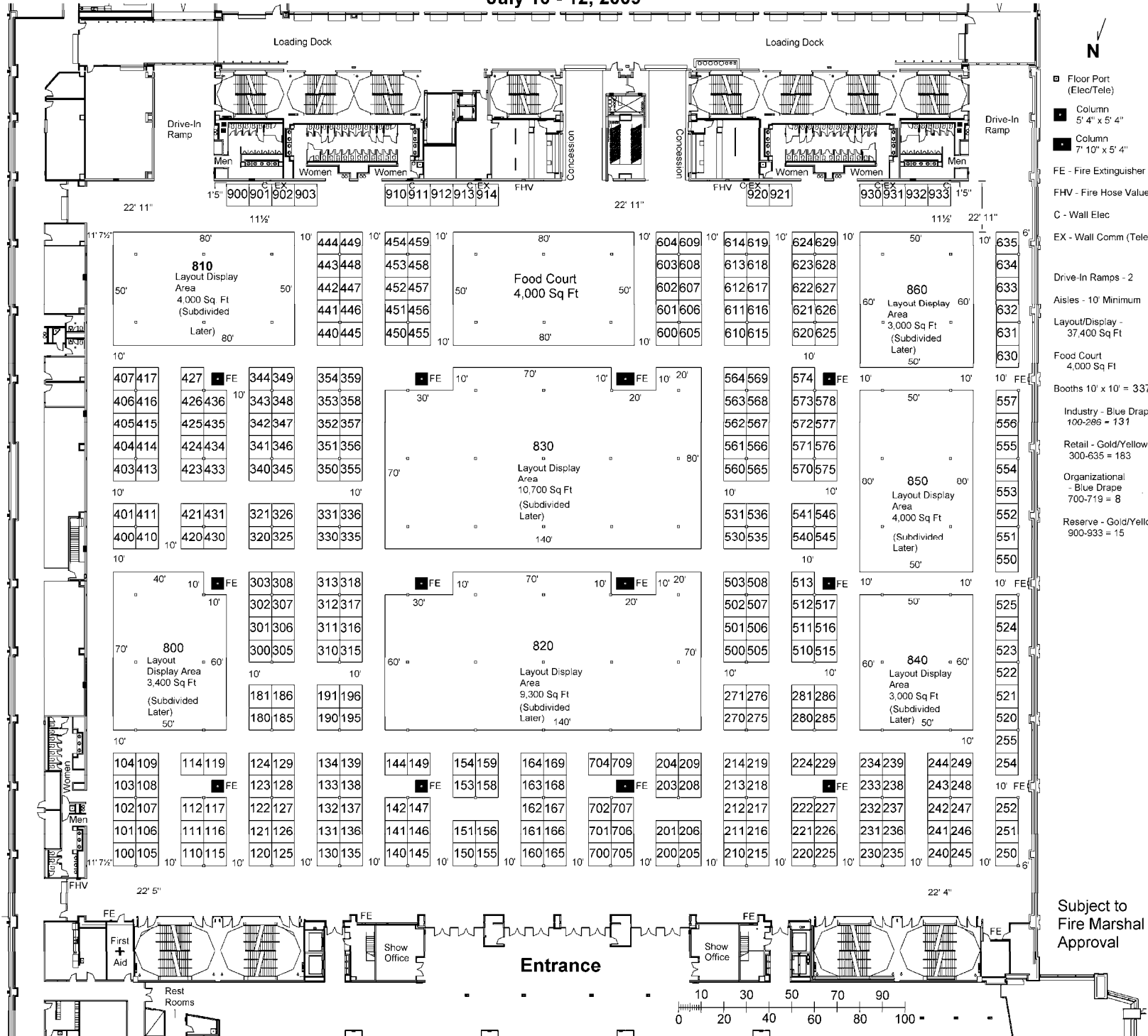

- Floor Port (Elec/Tele)
- Column 5' 4" x 5' 4"
- Column 7' 10" x 5' 4"
- FE - Fire Extinguisher
- FHV - Fire Hose Value
- C - Wall Elec
- EX - Wall Comm (Tele)
- Drive-In Ramps - 2
- Aisles - 10' Minimum
- Layout/Display - 37,400 Sq Ft
- Food Court 4,000 Sq Ft
- Booths 10' x 10' = 337
- Industry - Blue Drape 100-286 = 131
- Retail - Gold/Yellow 300-635 = 183
- Organizational - Blue Drape 700-719 = 8
- Reserve - Gold/Yellow 900-933 = 15

Subject to Fire Marshal Approval